

# SUNNICA ENERGY FARM

EN010106

Volume 2

2.5 Location Plan

APFP Regulation 5(2)(o)

Planning Act 2008

Infrastructure Planning (Applications: Prescribed Forms and  
Procedure) Regulations 2009



Planning Act 2008

**The Infrastructure Planning  
(Applications: Prescribed Forms and  
Procedure) Regulations 2009**

## **Sunnica Energy Farm**

### **2.5 Location Plan**

<b>Regulation Reference:</b>	Regulation 5(2)(o)
<b>Planning Inspectorate Scheme Reference</b>	EN010106
<b>Application Document Reference</b>	EN010106/APP/2.5
<b>Author</b>	Sunnica Energy Farm Project Team

<b>Version</b>	<b>Date</b>	<b>Status of Version</b>
Rev 00	18 November 2021	Application Version



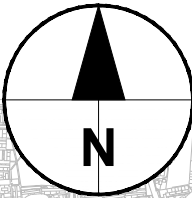
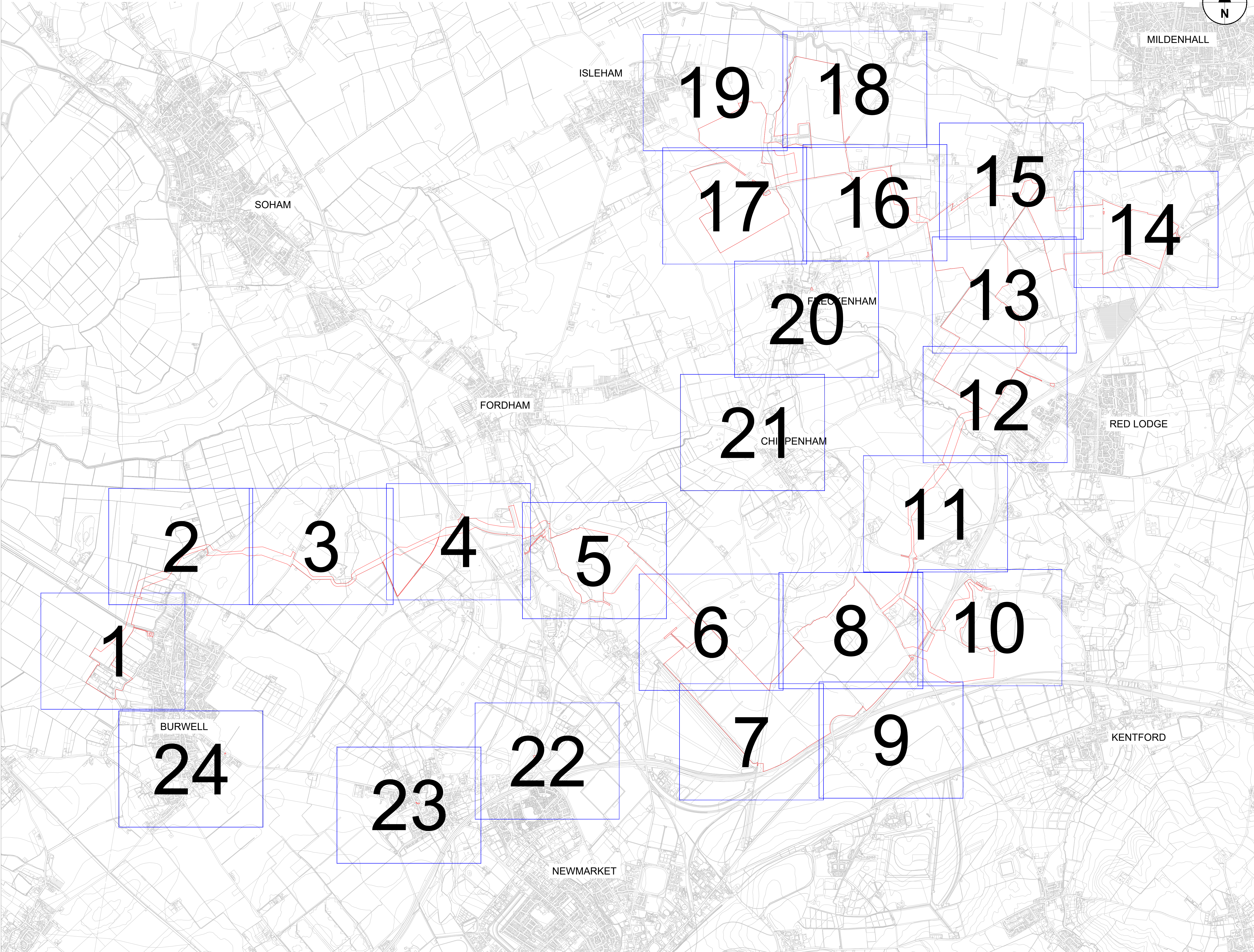

THIS DRAWING IS TO BE USED ONLY FOR THE PURPOSE OF ISSUE THAT IT WAS ISSUED FOR AND IS SUBJECT TO AMENDMENT

NOTES:

Order limits

Copyright:  
Contains OS data © Crown copyright and database right 2021  
Contains public sector information licensed under the Open Government Licence v3.0  
NOTE:  
Document Reference: EN010106/APP/2.5  
APFP Regulation: 5(2)(o)

Purpose of Issue  
FOR DCO SUBMISSION

Client  
SUNNICA LTD

Project Title  

Drawing Title  
SUNNICA ENERGY FARM LOCATION PLAN  
OVERVIEW PLAN

Drawn LE	Checked DW	Approved NC	Date 28/10/21
AECOM Internal Project No. 60589004		Scale @ A3 NOT TO SCALE	

THIS DOCUMENT HAS BEEN PREPARED PURSUANT TO AND SUBJECT TO THE TERMS OF AECOM'S APPOINTMENT BY ITS CLIENT. AECOM ACCEPTS NO LIABILITY FOR ANY USE OF THIS DOCUMENT OTHER THAN BY ITS ORIGINAL CLIENT OR FOLLOWING AECOM'S EXPRESS AGREEMENT TO SUCH USE, AND ONLY FOR THE PURPOSES FOR WHICH IT WAS PREPARED AND PROVIDED.

AECOM  
Unit 1 Wellbrook Court,  
Girton,  
Cambridge, CB3 0NA  
United Kingdom  
Telephone (01223) 488000  
www.aecom.com

Drawing Number EN010106/APP/2.5	Rev 0
------------------------------------	----------



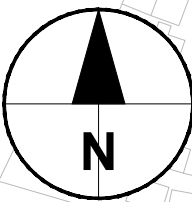
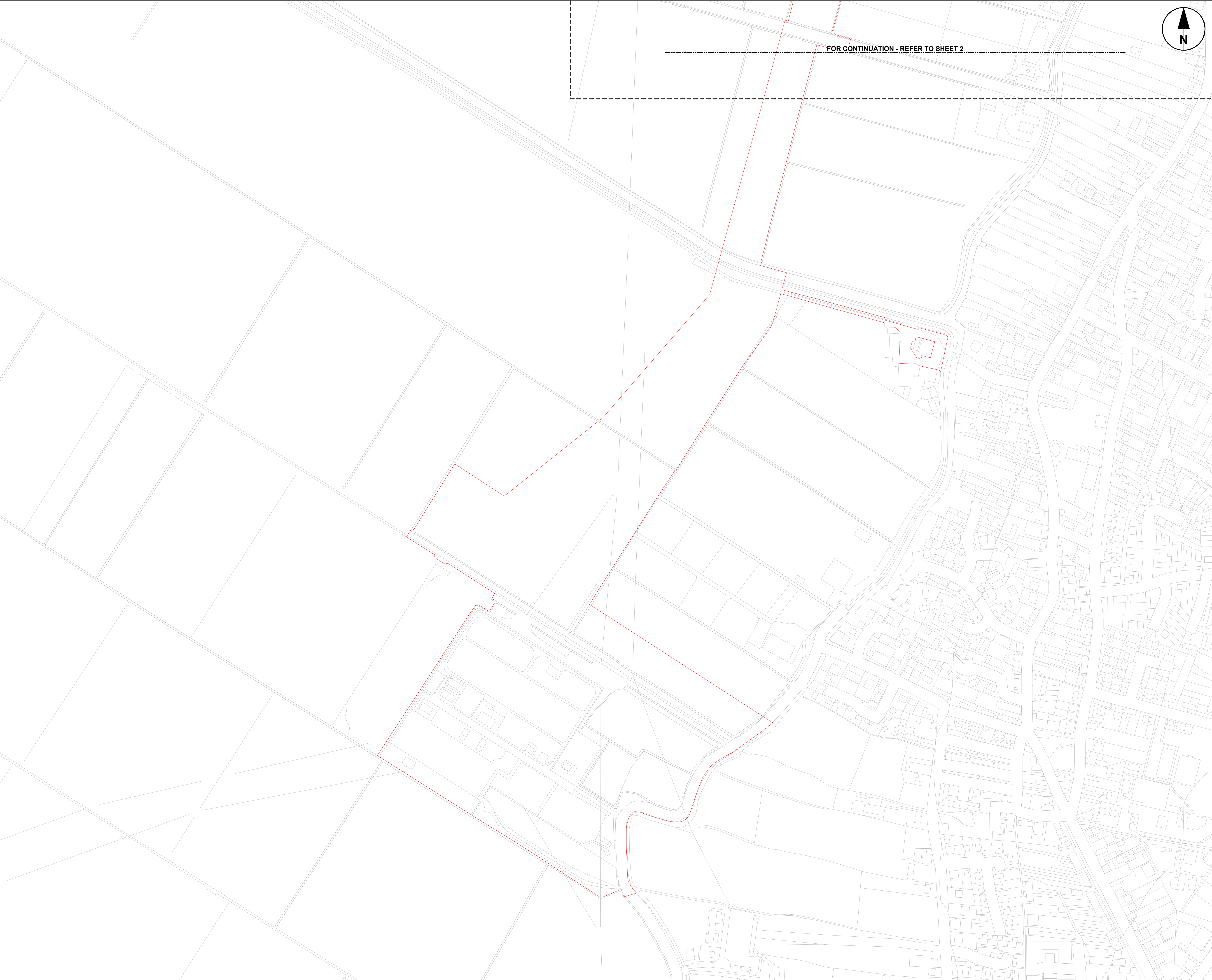

FOR CONTINUATION - REFER TO SHEET 2

THIS DRAWING IS TO BE USED ONLY FOR THE PURPOSE OF ISSUE THAT IT WAS ISSUED FOR AND IS SUBJECT TO AMENDMENT

NOTES:

Order limits

Copyright:  
Contains OS data © Crown copyright and database right 2021  
Contains public sector information licensed under the Open Government Licence v3.0  
NOTE:  
Document Reference: EN010106/APP/2.5  
APFP Regulation: 5(2)(o)

Purpose of Issue  
FOR DCO SUBMISSION

Client  
SUNNICA LTD



Drawing Title  
SUNNICA ENERGY FARM LOCATION PLAN  
SHEET 1 OF 24

Drawn LE	Checked DW	Approved NC	Date 28/10/21
-------------	---------------	----------------	------------------

AECOM Internal Project No. 60589004	Scale @ A3 1:2500
--	----------------------

THIS DOCUMENT HAS BEEN PREPARED PURSUANT TO AND SUBJECT TO THE TERMS OF AECOM'S APPOINTMENT BY ITS CLIENT. AECOM ACCEPTS NO LIABILITY FOR ANY USE OF THIS DOCUMENT OTHER THAN BY ITS ORIGINAL CLIENT OR FOLLOWING AECOM'S EXPRESS AGREEMENT TO SUCH USE, AND ONLY FOR THE PURPOSES FOR WHICH IT WAS PREPARED AND PROVIDED.

AECOM  
Unit 1 Wellbrook Court,  
Girton,  
Cambridge, CB3 0NA  
United Kingdom  
Telephone (01223) 488000  
www.aecom.com

Drawing Number EN010106/APP/2.5	Rev 0
------------------------------------	----------



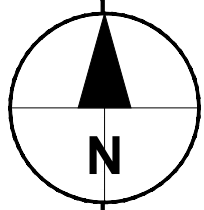

THIS DRAWING IS TO BE USED ONLY FOR THE PURPOSE OF ISSUE THAT IT WAS ISSUED FOR AND IS SUBJECT TO AMENDMENT

NOTES:

Order limits

Copyright:  
Contains OS data © Crown copyright and database right 2021  
Contains public sector information licensed under the Open Government Licence v3.0  
NOTE:  
Document Reference: EN010106/APP/2.5  
APFP Regulation: 5(2)(o)

Purpose of Issue  
FOR DCO SUBMISSION

Client  
SUNNICA LTD

Project Title  

Drawing Title  
SUNNICA ENERGY FARM LOCATION PLAN  
SHEET 2 OF 24

Drawn LE	Checked DW	Approved NC	Date 28/10/21
-------------	---------------	----------------	------------------

AECOM Internal Project No. 60589004	Scale @ A3 1:2500
--	----------------------

THIS DOCUMENT HAS BEEN PREPARED PURSUANT TO AND SUBJECT TO THE TERMS OF AECOM'S APPOINTMENT BY ITS CLIENT. AECOM ACCEPTS NO LIABILITY FOR ANY USE OF THIS DOCUMENT OTHER THAN BY ITS ORIGINAL CLIENT OR FOLLOWING AECOM'S EXPRESS AGREEMENT TO SUCH USE, AND ONLY FOR THE PURPOSES FOR WHICH IT WAS PREPARED AND PROVIDED.

AECOM  
Unit 1 Wellbrook Court,  
Girton,  
Cambridge, CB3 0NA  
United Kingdom  
Telephone (01223) 488000  
www.aecom.com

Drawing Number EN010106/APP/2.5	Rev 0
------------------------------------	----------

FOR CONTINUATION - REFER TO SHEET 3

FOR CONTINUATION - REFER TO SHEET 1



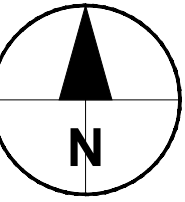

THIS DRAWING IS TO BE USED ONLY FOR THE PURPOSE OF ISSUE THAT IT WAS ISSUED FOR AND IS SUBJECT TO AMENDMENT

NOTES:

Order limits

Copyright:  
Contains OS data © Crown copyright and database right 2021  
Contains public sector information licensed under the Open Government Licence v3.0  
NOTE:  
Document Reference: EN010106/APP/2.5  
APFP Regulation: 5(2)(o)

Purpose of Issue  
FOR DCO SUBMISSION

Client  
SUNNICA LTD

Project Title  

Drawing Title  
SUNNICA ENERGY FARM LOCATION PLAN  
SHEET 3 OF 24

Drawn LE	Checked DW	Approved NC	Date 28/10/21
AECOM Internal Project No. 60589004		Scale @ A3 1:2500	

THIS DOCUMENT HAS BEEN PREPARED PURSUANT TO AND SUBJECT TO THE TERMS OF AECOM'S APPOINTMENT BY ITS CLIENT. AECOM ACCEPTS NO LIABILITY FOR ANY USE OF THIS DOCUMENT OTHER THAN BY ITS ORIGINAL CLIENT OR FOLLOWING AECOM'S EXPRESS AGREEMENT TO SUCH USE, AND ONLY FOR THE PURPOSES FOR WHICH IT WAS PREPARED AND PROVIDED.

AECOM  
Unit 1 Wellbrook Court,  
Girton,  
Cambridge, CB3 0NA  
United Kingdom  
Telephone (01223) 488000  
www.aecom.com

Drawing Number EN010106/APP/2.5	Rev 0
------------------------------------	----------



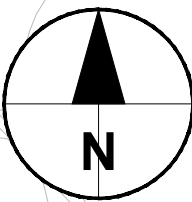

THIS DRAWING IS TO BE USED ONLY FOR THE PURPOSE OF ISSUE THAT IT WAS ISSUED FOR AND IS SUBJECT TO AMENDMENT

NOTES:

Order limits

Copyright:  
Contains OS data © Crown copyright and database right 2021  
Contains public sector information licensed under the Open Government Licence v3.0  
NOTE:  
Document Reference: EN010106/APP/2.5  
APFP Regulation: 5(2)(o)

Purpose of Issue  
FOR DCO SUBMISSION

Client  
SUNNICA LTD

Project Title  

Drawing Title  
SUNNICA ENERGY FARM LOCATION PLAN  
SHEET 4 OF 24

Drawn LE	Checked DW	Approved NC	Date 28/10/21
AECOM Internal Project No. 60589004		Scale @ A3 1:2500	

THIS DOCUMENT HAS BEEN PREPARED PURSUANT TO AND SUBJECT TO THE TERMS OF AECOM'S APPOINTMENT BY ITS CLIENT. AECOM ACCEPTS NO LIABILITY FOR ANY USE OF THIS DOCUMENT OTHER THAN BY ITS ORIGINAL CLIENT OR FOLLOWING AECOM'S EXPRESS AGREEMENT TO SUCH USE, AND ONLY FOR THE PURPOSES FOR WHICH IT WAS PREPARED AND PROVIDED.

AECOM  
Unit 1 Wellbrook Court,  
Gilton,  
Cambridge, CB3 0NA  
United Kingdom  
Telephone (01223) 488000  
www.aecom.com

Drawing Number EN010106/APP/2.5	Rev 0
------------------------------------	----------



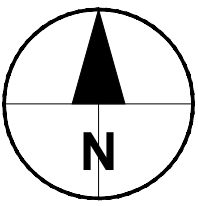

THIS DRAWING IS TO BE USED ONLY FOR THE PURPOSE OF ISSUE THAT IT WAS ISSUED FOR AND IS SUBJECT TO AMENDMENT

NOTES:

Order limits

Copyright:  
Contains OS data © Crown copyright and database right 2021  
Contains public sector information licensed under the Open Government Licence v3.0  
NOTE:  
Document Reference: EN010106/APP/2.5  
APFP Regulation: 5(2)(o)

Purpose of Issue  
FOR DCO SUBMISSION

Client  
SUNNICA LTD

Project Title  

Drawing Title  
SUNNICA ENERGY FARM LOCATION PLAN  
SHEET 5 OF 24

Drawn LE	Checked DW	Approved NC	Date 28/10/21
-------------	---------------	----------------	------------------

AECOM Internal Project No. 60589004	Scale @ A3 1:2500
--	----------------------

THIS DOCUMENT HAS BEEN PREPARED PURSUANT TO AND SUBJECT TO THE TERMS OF AECOM'S APPOINTMENT BY ITS CLIENT. AECOM ACCEPTS NO LIABILITY FOR ANY USE OF THIS DOCUMENT OTHER THAN BY ITS ORIGINAL CLIENT OR FOLLOWING AECOM'S EXPRESS AGREEMENT TO SUCH USE, AND ONLY FOR THE PURPOSES FOR WHICH IT WAS PREPARED AND PROVIDED.

AECOM  
Unit 1 Wellbrook Court,  
Girton,  
Cambridge, CB3 0NA  
United Kingdom  
Telephone (01223) 488000  
www.aecom.com

Drawing Number EN010106/APP/2.5	Rev 0
------------------------------------	----------



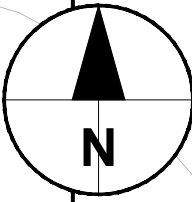

THIS DRAWING IS TO BE USED ONLY FOR THE PURPOSE OF ISSUE THAT IT WAS ISSUED FOR AND IS SUBJECT TO AMENDMENT

**NOTES:**

Order limits

Copyright:  
Contains OS data © Crown copyright and database right 2021  
Contains public sector information licensed under the Open Government Licence v3.0

NOTE:  
Document Reference: EN010106/APP/2.5  
APFP Regulation: 5(2)(o)

Purpose of Issue  
**FOR DCO SUBMISSION**

Client  
**SUNNICA LTD**



Drawing Title  
**SUNNICA ENERGY FARM LOCATION PLAN  
SHEET 6 OF 24**

Drawn LE	Checked DW	Approved NC	Date 28/10/21
AECOM Internal Project No. 60589004		Scale @ A3 1:2500	
THIS DOCUMENT HAS BEEN PREPARED PURSUANT TO AND SUBJECT TO THE TERMS OF AECOM'S APPOINTMENT BY ITS CLIENT. AECOM ACCEPTS NO LIABILITY FOR ANY USE OF THIS DOCUMENT OTHER THAN BY ITS ORIGINAL CLIENT OR FOLLOWING AECOM'S EXPRESS AGREEMENT TO SUCH USE, AND ONLY FOR THE PURPOSES FOR WHICH IT WAS PREPARED AND PROVIDED.			
AECOM Unit 1 Wellbrook Court, Gilton, Cambridge, CB3 0NA United Kingdom Telephone (01223) 488000 www.aecom.com			
Drawing Number EN010106/APP/2.5			Rev 0



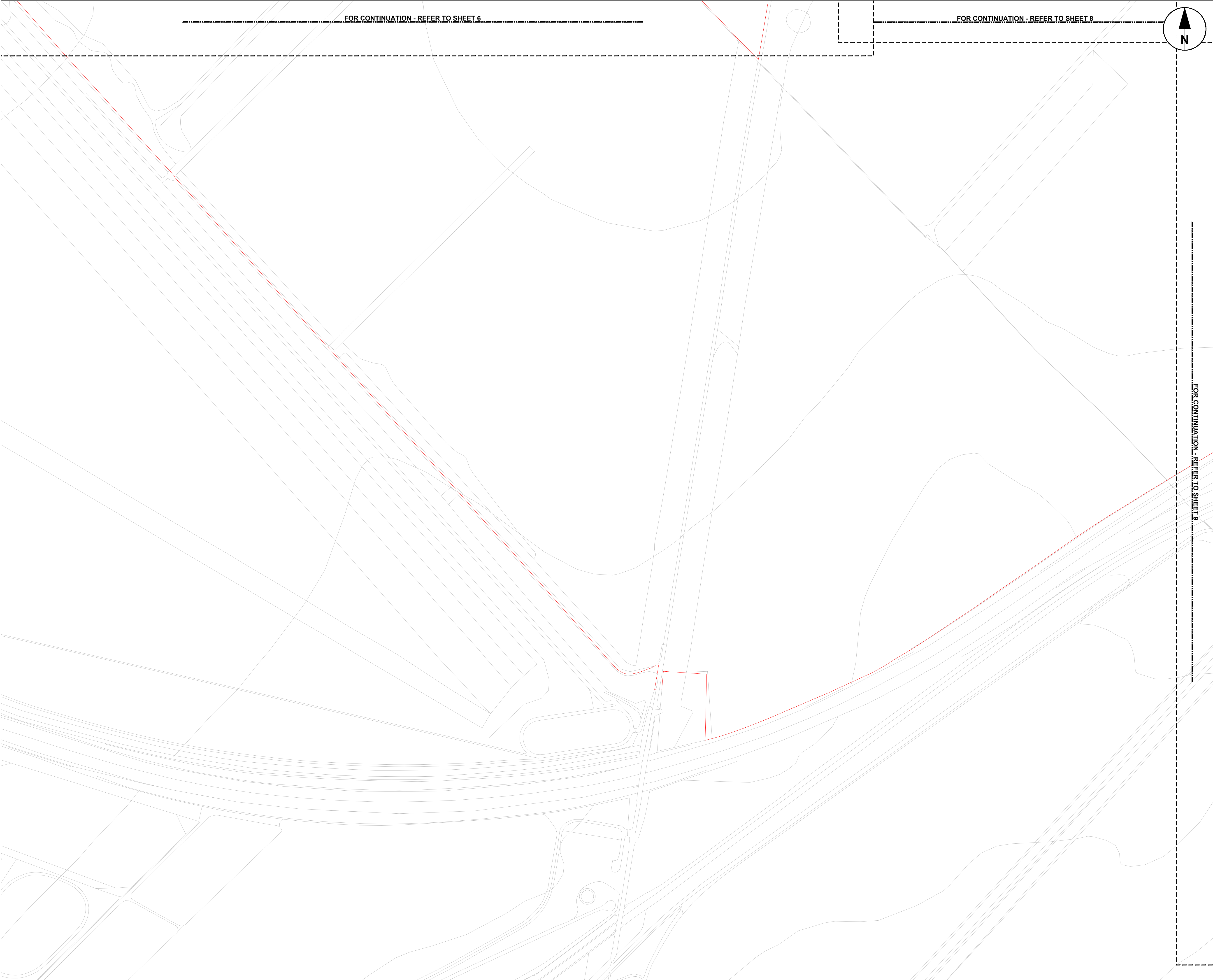

FOR CONTINUATION - REFER TO SHEET 6

FOR CONTINUATION - REFER TO SHEET 8

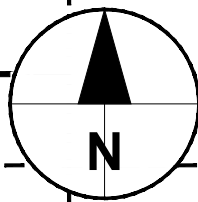

THIS DRAWING IS TO BE USED ONLY FOR THE PURPOSE OF ISSUE THAT IT WAS ISSUED FOR AND IS SUBJECT TO AMENDMENT

NOTES:

Order limits

Copyright:  
Contains OS data © Crown copyright and database right 2021  
Contains public sector information licensed under the Open Government Licence v3.0  
NOTE:  
Document Reference: EN010106/APP/2.5  
APFP Regulation: 5(2)(o)

Purpose of Issue  
FOR DCO SUBMISSION

Client  
SUNNICA LTD

Project Title  

Drawing Title  
SUNNICA ENERGY FARM LOCATION PLAN  
SHEET 7 OF 24

Drawn LE	Checked DW	Approved NC	Date 28/10/21
-------------	---------------	----------------	------------------

AECOM Internal Project No. 60589004	Scale @ A3 1:2500
--	----------------------

THIS DOCUMENT HAS BEEN PREPARED PURSUANT TO AND SUBJECT TO THE TERMS OF AECOM'S APPOINTMENT BY ITS CLIENT. AECOM ACCEPTS NO LIABILITY FOR ANY USE OF THIS DOCUMENT OTHER THAN BY ITS ORIGINAL CLIENT OR FOLLOWING AECOM'S EXPRESS AGREEMENT TO SUCH USE, AND ONLY FOR THE PURPOSES FOR WHICH IT WAS PREPARED AND PROVIDED.

AECOM  
Unit 1 Wellbrook Court,  
Gilton,  
Cambridge, CB3 0NA  
United Kingdom  
Telephone (01223) 488000  
www.aecom.com

Drawing Number EN010106/APP/2.5	Rev 0
------------------------------------	----------



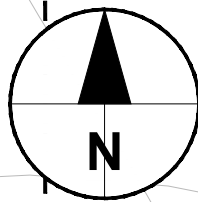

THIS DRAWING IS TO BE USED ONLY FOR THE PURPOSE OF ISSUE THAT IT WAS ISSUED FOR AND IS SUBJECT TO AMENDMENT

NOTES:

Order limits

Copyright:  
Contains OS data © Crown copyright and database right 2021  
Contains public sector information licensed under the Open Government Licence v3.0  
NOTE:  
Document Reference: EN010106/APP/2.5  
APFP Regulation: 5(2)(a)

Purpose of Issue  
**FOR DCO SUBMISSION**

Client  
**SUNNICA LTD**

Project Title  

Drawing Title  
**SUNNICA ENERGY FARM LOCATION PLAN  
SHEET 8 OF 24**

Drawn <b>LE</b>	Checked <b>DW</b>	Approved <b>NC</b>	Date <b>28/10/21</b>
AECOM Internal Project No. <b>60589004</b>		Scale @ A3 <b>1:2500</b>	

THIS DOCUMENT HAS BEEN PREPARED PURSUANT TO AND SUBJECT TO THE TERMS OF AECOM'S APPOINTMENT BY ITS CLIENT. AECOM ACCEPTS NO LIABILITY FOR ANY USE OF THIS DOCUMENT OTHER THAN BY ITS ORIGINAL CLIENT OR FOLLOWING AECOM'S EXPRESS AGREEMENT TO SUCH USE, AND ONLY FOR THE PURPOSES FOR WHICH IT WAS PREPARED AND PROVIDED.

AECOM  
Unit 1 Wellbrook Court,  
Girton,  
Cambridge, CB3 0NA  
United Kingdom  
Telephone (01223) 488000  
www.aecom.com

Drawing Number <b>EN010106/APP/2.5</b>	Rev <b>0</b>
---	-----------------





FOR CONTINUATION - REFER TO SHEET 8

FOR CONTINUATION - REFER TO SHEET 10

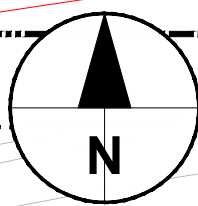

THIS DRAWING IS TO BE USED ONLY FOR THE PURPOSE OF ISSUE THAT IT WAS ISSUED FOR AND IS SUBJECT TO AMENDMENT

NOTES:

Order limits

Copyright:  
Contains OS data © Crown copyright and database right 2021  
Contains public sector information licensed under the Open Government Licence v3.0  
NOTE:  
Document Reference: EN010106/APP/2.5  
APFP Regulation: 5(2)(o)

Purpose of Issue  
FOR DCO SUBMISSION

Client  
SUNNICA LTD



Drawing Title  
SUNNICA ENERGY FARM LOCATION PLAN  
SHEET 9 OF 24

Drawn LE	Checked DW	Approved NC	Date 28/10/21
-------------	---------------	----------------	------------------

AECOM Internal Project No. 60589004	Scale @ A3 1:2500
--	----------------------

THIS DOCUMENT HAS BEEN PREPARED PURSUANT TO AND SUBJECT TO THE TERMS OF AECOM'S APPOINTMENT BY ITS CLIENT. AECOM ACCEPTS NO LIABILITY FOR ANY USE OF THIS DOCUMENT OTHER THAN BY ITS ORIGINAL CLIENT OR FOLLOWING AECOM'S EXPRESS AGREEMENT TO SUCH USE, AND ONLY FOR THE PURPOSES FOR WHICH IT WAS PREPARED AND PROVIDED.

AECOM  
Unit 1 Wellbrook Court,  
Girton,  
Cambridge, CB3 0NA  
United Kingdom  
Telephone (01223) 488000  
www.aecom.com

Drawing Number EN010106/APP/2.5	Rev 0
------------------------------------	----------



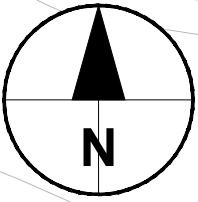

THIS DRAWING IS TO BE USED ONLY FOR THE PURPOSE OF ISSUE THAT IT WAS ISSUED FOR AND IS SUBJECT TO AMENDMENT

NOTES:

Order limits

Copyright:  
Contains OS data © Crown copyright and database right 2021  
Contains public sector information licensed under the Open Government Licence v3.0  
NOTE:  
Document Reference: EN010106/APP/2.5  
APFP Regulation: 5(2)(o)

Purpose of Issue  
FOR DCO SUBMISSION

Client  
SUNNICA LTD

Project Title  

Drawing Title  
SUNNICA ENERGY FARM LOCATION PLAN  
SHEET 10 OF 24

Drawn LE	Checked DW	Approved NC	Date 28/10/21
AECOM Internal Project No. 60589004		Scale @ A3 1:2500	

THIS DOCUMENT HAS BEEN PREPARED PURSUANT TO AND SUBJECT TO THE TERMS OF AECOM'S APPOINTMENT BY ITS CLIENT. AECOM ACCEPTS NO LIABILITY FOR ANY USE OF THIS DOCUMENT OTHER THAN BY ITS ORIGINAL CLIENT OR FOLLOWING AECOM'S EXPRESS AGREEMENT TO SUCH USE, AND ONLY FOR THE PURPOSES FOR WHICH IT WAS PREPARED AND PROVIDED.

AECOM  
Unit 1 Wellbrook Court,  
Girton,  
Cambridge, CB3 0NA  
United Kingdom  
Telephone (01223) 488000  
www.aecom.com

Drawing Number EN010106/APP/2.5	Rev 0
------------------------------------	----------



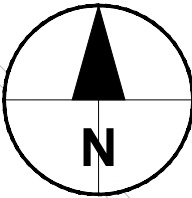
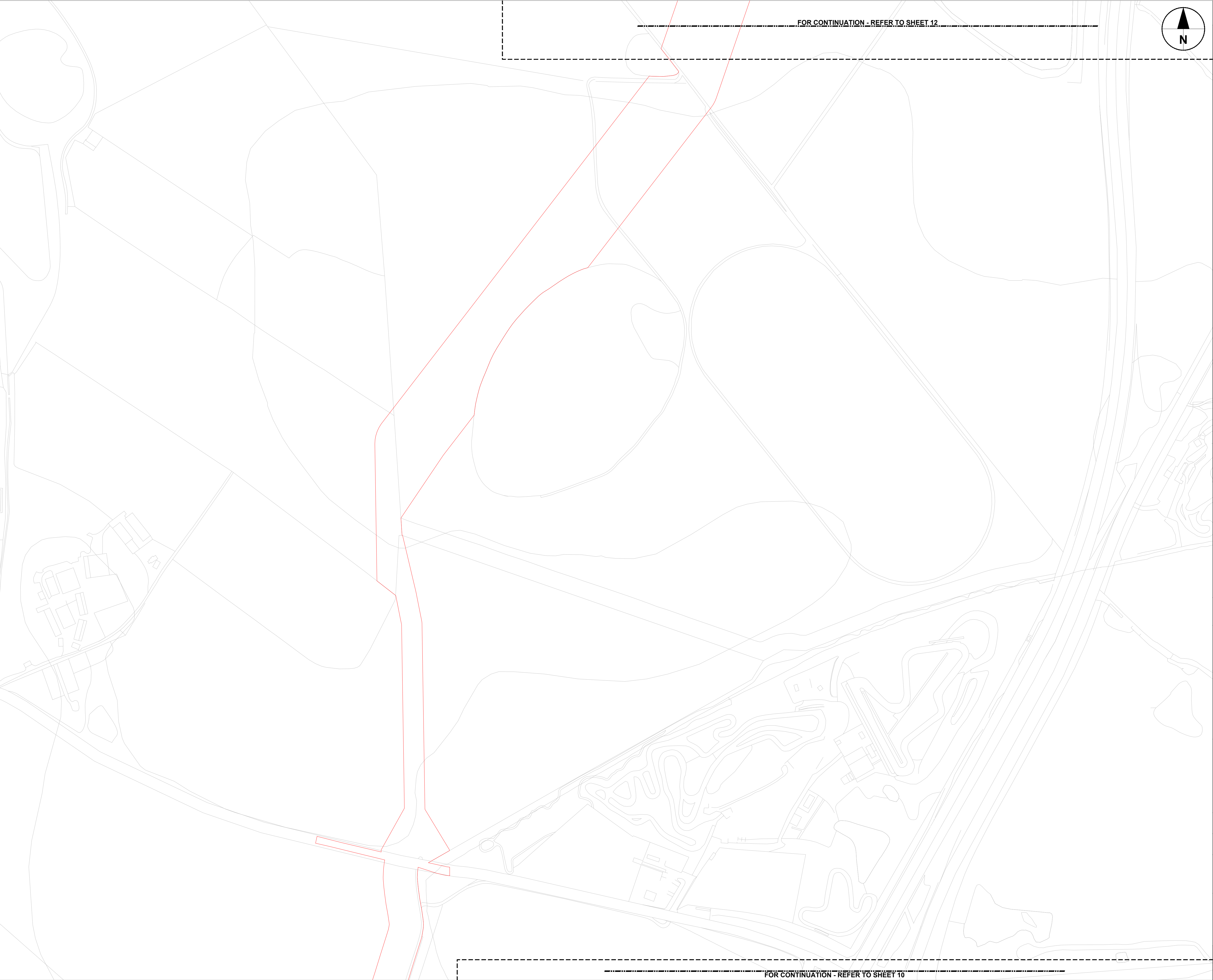

THIS DRAWING IS TO BE USED ONLY FOR THE PURPOSE OF ISSUE THAT IT WAS ISSUED FOR AND IS SUBJECT TO AMENDMENT

NOTES:

Order limits

Copyright:  
Contains OS data © Crown copyright and database right 2021  
Contains public sector information licensed under the Open Government Licence v3.0  
NOTE:  
Document Reference: EN010106/APP/2.5  
APFP Regulation: 5(2)(o)

Purpose of Issue  
FOR DCO SUBMISSION

Client  
SUNNICA LTD



Drawing Title  
SUNNICA ENERGY FARM LOCATION PLAN  
SHEET 11 OF 24

Drawn LE	Checked DW	Approved NC	Date 28/10/21
-------------	---------------	----------------	------------------

AECOM Internal Project No. 60589004	Scale @ A3 1:2500
--	----------------------

THIS DOCUMENT HAS BEEN PREPARED PURSUANT TO AND SUBJECT TO THE TERMS OF AECOM'S APPOINTMENT BY ITS CLIENT. AECOM ACCEPTS NO LIABILITY FOR ANY USE OF THIS DOCUMENT OTHER THAN BY ITS ORIGINAL CLIENT OR FOLLOWING AECOM'S EXPRESS AGREEMENT TO SUCH USE, AND ONLY FOR THE PURPOSES FOR WHICH IT WAS PREPARED AND PROVIDED.

AECOM  
Unit 1 Wellbrook Court,  
Girton,  
Cambridge, CB3 0NA  
United Kingdom  
Telephone (01223) 488000  
www.aecom.com

Drawing Number EN010106/APP/2.5	Rev 0
------------------------------------	----------



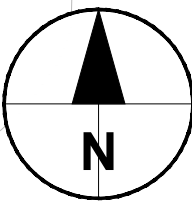
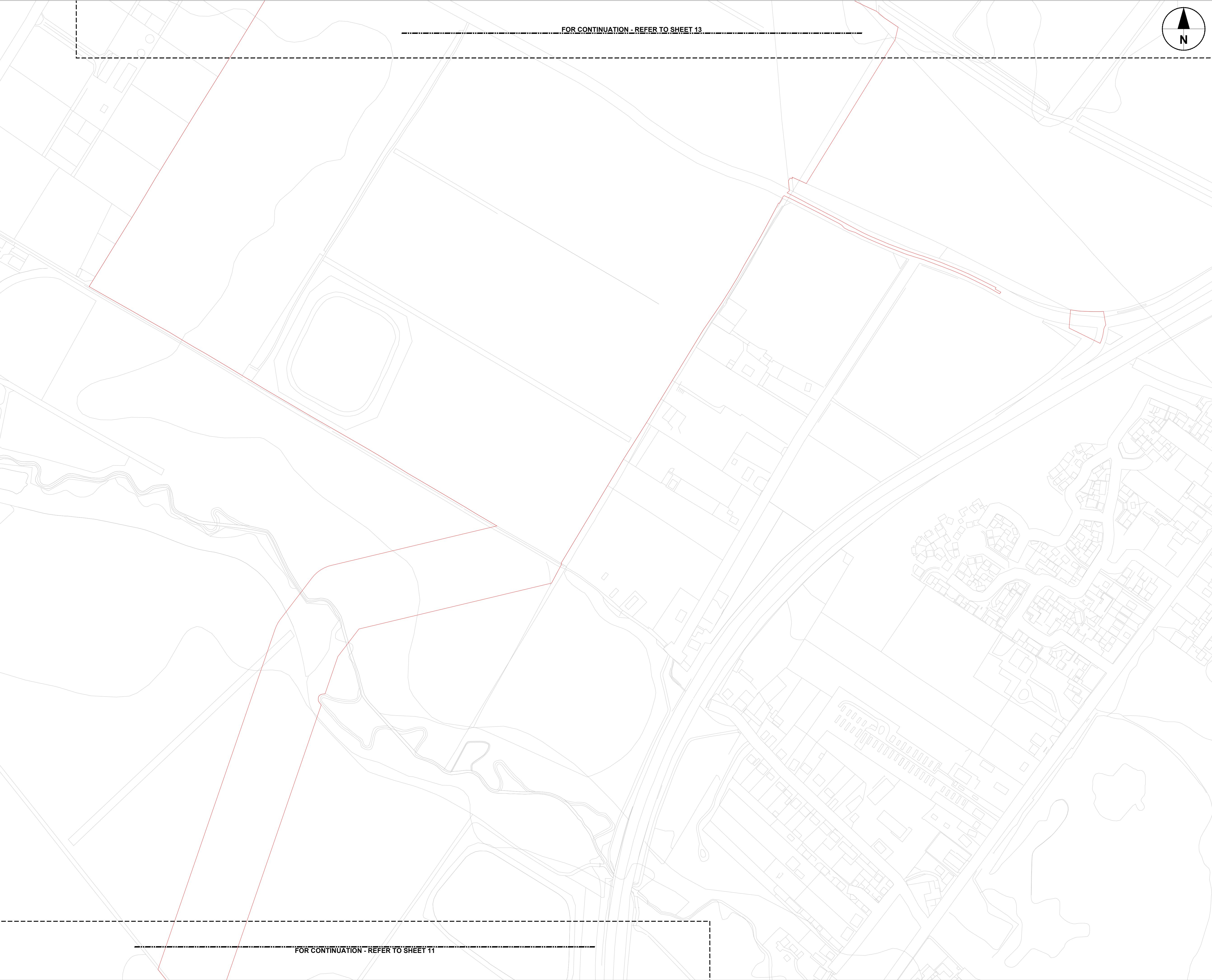

THIS DRAWING IS TO BE USED ONLY FOR THE PURPOSE OF ISSUE THAT IT WAS ISSUED FOR AND IS SUBJECT TO AMENDMENT

NOTES:

— Order limits

Copyright:  
Contains OS data © Crown copyright and database right 2021  
Contains public sector information licensed under the Open Government Licence v3.0  
NOTE:  
Document Reference: EN010106/APP/2.5  
APFP Regulation: 5(2)(o)

Purpose of Issue  
**FOR DCO SUBMISSION**

Client  
**SUNNICA LTD**



Drawing Title  
**SUNNICA ENERGY FARM LOCATION PLAN  
SHEET 12 OF 24**

Drawn <b>LE</b>	Checked <b>DW</b>	Approved <b>NC</b>	Date <b>28/10/21</b>
--------------------	----------------------	-----------------------	-------------------------

AECOM Internal Project No. <b>60589004</b>	Scale @ A3 <b>1:2500</b>
---	-----------------------------

THIS DOCUMENT HAS BEEN PREPARED PURSUANT TO AND SUBJECT TO THE TERMS OF AECOM'S APPOINTMENT BY ITS CLIENT. AECOM ACCEPTS NO LIABILITY FOR ANY USE OF THIS DOCUMENT OTHER THAN BY ITS ORIGINAL CLIENT OR FOLLOWING AECOM'S EXPRESS AGREEMENT TO SUCH USE, AND ONLY FOR THE PURPOSES FOR WHICH IT WAS PREPARED AND PROVIDED.

AECOM  
Unit 1 Wellbrook Court,  
Girton,  
Cambridge, CB3 0NA  
United Kingdom  
Telephone (01223) 488000  
www.aecom.com

Drawing Number <b>EN010106/APP/2.5</b>	Rev <b>0</b>
---	-----------------



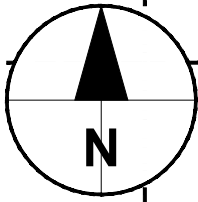

THIS DRAWING IS TO BE USED ONLY FOR THE PURPOSE OF ISSUE THAT IT WAS ISSUED FOR AND IS SUBJECT TO AMENDMENT

NOTES:

Order limits

Copyright:  
Contains OS data © Crown copyright and database right 2021  
Contains public sector information licensed under the Open Government Licence v3.0  
NOTE:  
Document Reference: EN010106/APP/2.5  
APFP Regulation: 5(2)(o)

Purpose of Issue  
FOR DCO SUBMISSION

Client  
SUNNICA LTD

Project Title  

Drawing Title  
SUNNICA ENERGY FARM LOCATION PLAN  
SHEET 13 OF 24

Drawn LE	Checked DW	Approved NC	Date 28/10/21
-------------	---------------	----------------	------------------

AECOM Internal Project No. 60589004	Scale @ A3 1:2500
--	----------------------

THIS DOCUMENT HAS BEEN PREPARED PURSUANT TO AND SUBJECT TO THE TERMS OF AECOM'S APPOINTMENT BY ITS CLIENT. AECOM ACCEPTS NO LIABILITY FOR ANY USE OF THIS DOCUMENT OTHER THAN BY ITS ORIGINAL CLIENT OR FOLLOWING AECOM'S EXPRESS AGREEMENT TO SUCH USE, AND ONLY FOR THE PURPOSES FOR WHICH IT WAS PREPARED AND PROVIDED.

AECOM  
Unit 1 Wellbrook Court,  
Girton,  
Cambridge, CB3 0NA  
United Kingdom  
Telephone (01223) 488000  
www.aecom.com

Drawing Number EN010106/APP/2.5	Rev 0
------------------------------------	----------



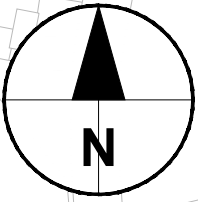

THIS DRAWING IS TO BE USED ONLY FOR THE PURPOSE OF ISSUE THAT IT WAS ISSUED FOR AND IS SUBJECT TO AMENDMENT

NOTES:

Order limits

Copyright:  
Contains OS data © Crown copyright and database right 2021  
Contains public sector information licensed under the Open Government Licence v3.0  
NOTE:  
Document Reference: EN010106/APP/2.5  
APFP Regulation: 5(2)(a)

Purpose of Issue  
FOR DCO SUBMISSION

Client  
SUNNICA LTD

Project Title  

Drawing Title  
SUNNICA ENERGY FARM LOCATION PLAN  
SHEET 14 OF 24

Drawn LE	Checked DW	Approved NC	Date 28/10/21
AECOM Internal Project No. 60589004		Scale @ A3 1:2500	

THIS DOCUMENT HAS BEEN PREPARED PURSUANT TO AND SUBJECT TO THE TERMS OF AECOM'S APPOINTMENT BY ITS CLIENT. AECOM ACCEPTS NO LIABILITY FOR ANY USE OF THIS DOCUMENT OTHER THAN BY ITS ORIGINAL CLIENT OR FOLLOWING AECOM'S EXPRESS AGREEMENT TO SUCH USE, AND ONLY FOR THE PURPOSES FOR WHICH IT WAS PREPARED AND PROVIDED.

AECOM  
Unit 1 Wellbrook Court,  
Gilton,  
Cambridge, CB3 0NA  
United Kingdom  
Telephone (01223) 488000  
www.aecom.com

Drawing Number EN010106/APP/2.5	Rev 0
------------------------------------	----------



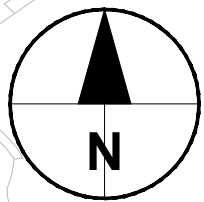
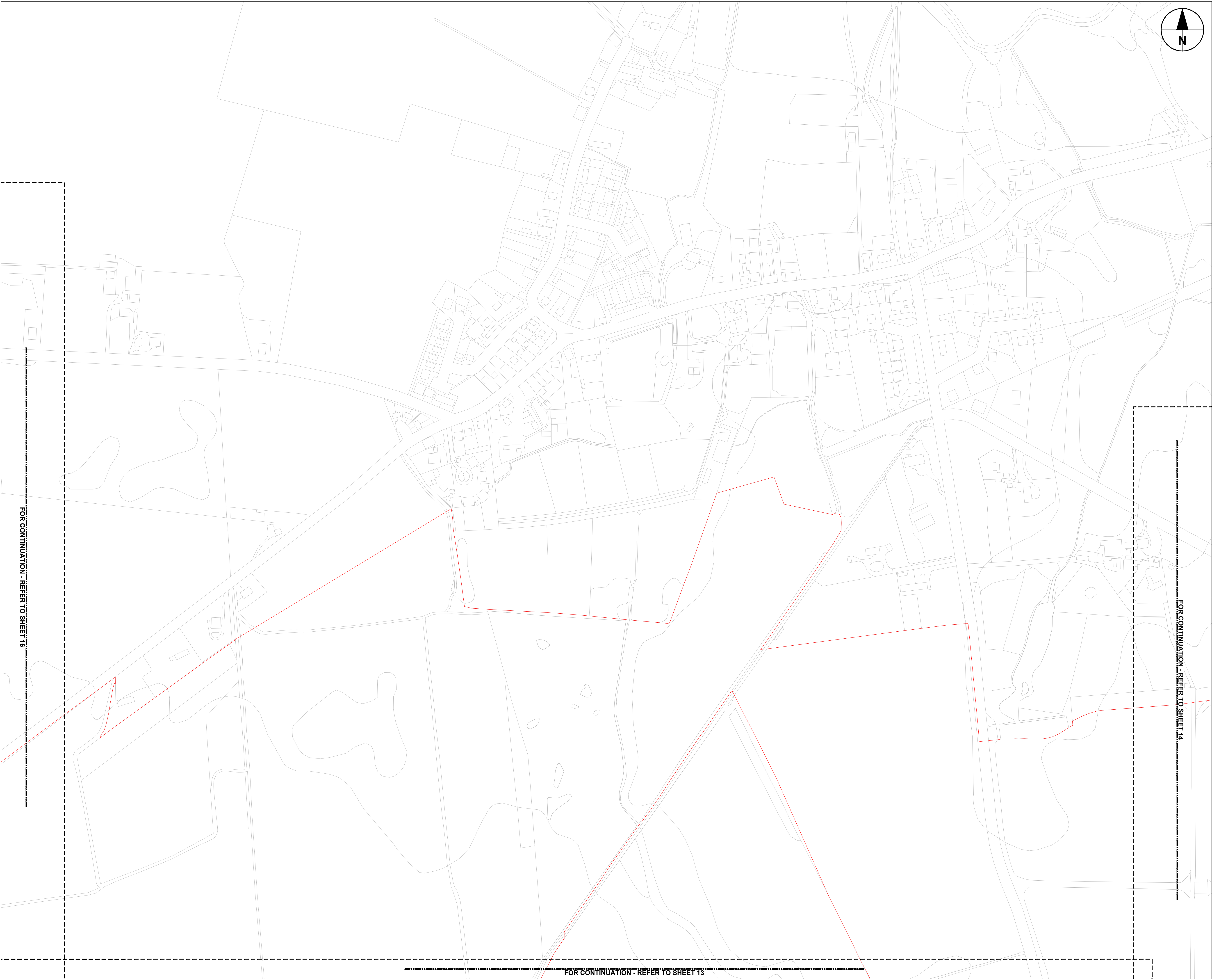

THIS DRAWING IS TO BE USED ONLY FOR THE PURPOSE OF ISSUE THAT IT WAS ISSUED FOR AND IS SUBJECT TO AMENDMENT

NOTES:

Order limits

Copyright:  
Contains OS data © Crown copyright and database right 2021  
Contains public sector information licensed under the Open Government Licence v3.0  
NOTE:  
Document Reference: EN010106/APP/2.5  
APFP Regulation: 5(2)(o)

Purpose of Issue  
**FOR DCO SUBMISSION**

Client  
**SUNNICA LTD**

Project Title  

Drawing Title  
**SUNNICA ENERGY FARM LOCATION PLAN  
SHEET 15 OF 24**

Drawn LE	Checked DW	Approved NC	Date 28/10/21
AECOM Internal Project No. <b>60589004</b>		Scale @ A3 <b>1:2500</b>	

THIS DOCUMENT HAS BEEN PREPARED PURSUANT TO AND SUBJECT TO THE TERMS OF AECOM'S APPOINTMENT BY ITS CLIENT. AECOM ACCEPTS NO LIABILITY FOR ANY USE OF THIS DOCUMENT OTHER THAN BY ITS ORIGINAL CLIENT OR FOLLOWING AECOM'S EXPRESS AGREEMENT TO SUCH USE, AND ONLY FOR THE PURPOSES FOR WHICH IT WAS PREPARED AND PROVIDED.

AECOM  
Unit 1 Wellbrook Court,  
Girton,  
Cambridge, CB3 0NA  
United Kingdom  
Telephone (01223) 488000  
www.aecom.com

Drawing Number <b>EN010106/APP/2.5</b>	Rev <b>0</b>
---	-----------------



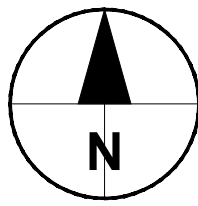
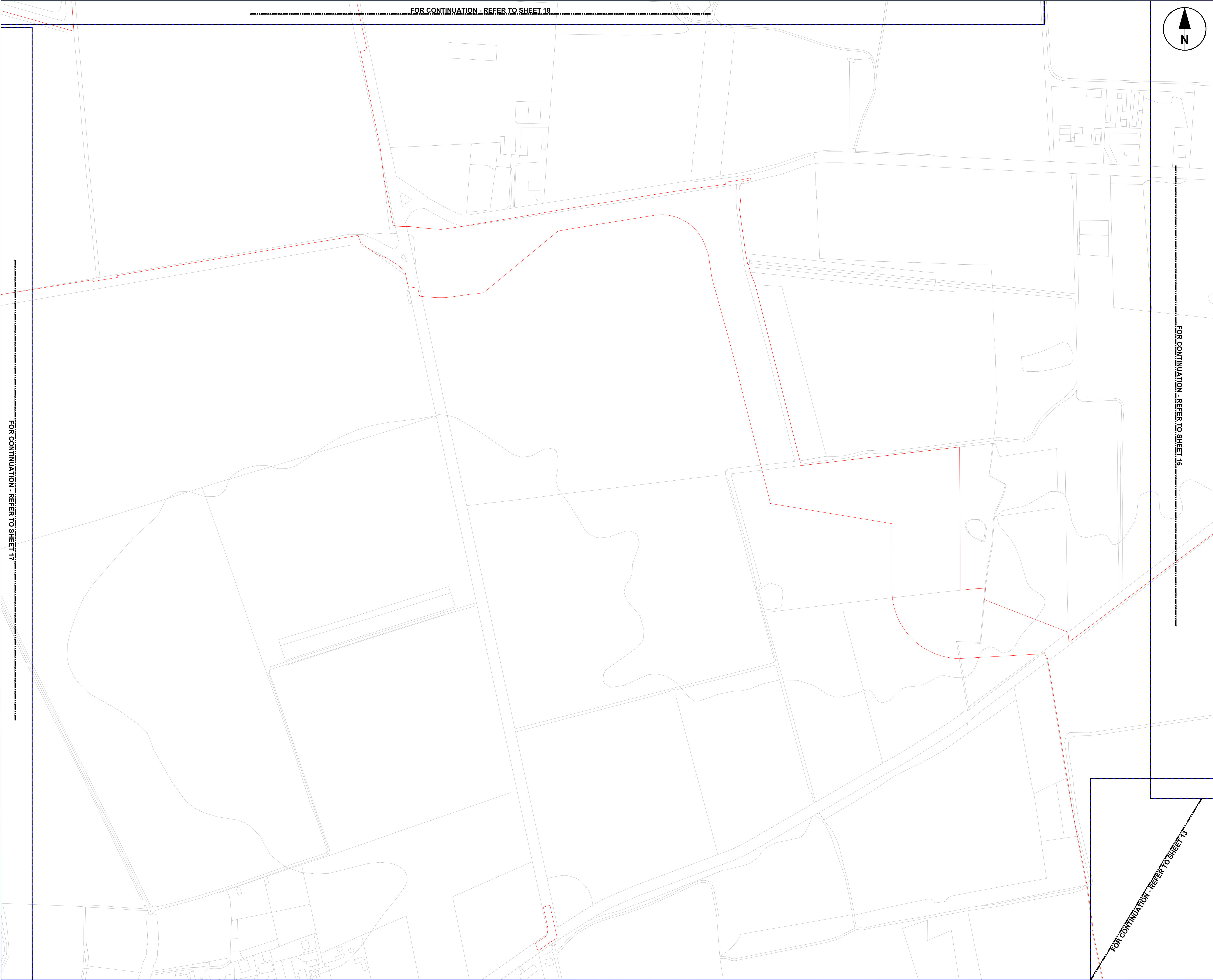

THIS DRAWING IS TO BE USED ONLY FOR THE PURPOSE OF ISSUE THAT IT WAS ISSUED FOR AND IS SUBJECT TO AMENDMENT

NOTES:

Order limits

Copyright:  
Contains OS data © Crown copyright and database right 2021  
Contains public sector information licensed under the Open Government Licence v3.0  
NOTE:  
Document Reference: EN010106/APP/2.5  
APFP Regulation: 5(2)(o)

Purpose of Issue  
**FOR DCO SUBMISSION**

Client  
**SUNNICA LTD**

Project Title  

Drawing Title  
**SUNNICA ENERGY FARM LOCATION PLAN  
SHEET 16 OF 24**

Drawn LE	Checked DW	Approved NC	Date 28/10/21
AECOM Internal Project No. 60589004		Scale @ A3 1:2500	

THIS DOCUMENT HAS BEEN PREPARED PURSUANT TO AND SUBJECT TO THE TERMS OF AECOM'S APPOINTMENT BY ITS CLIENT. AECOM ACCEPTS NO LIABILITY FOR ANY USE OF THIS DOCUMENT OTHER THAN BY ITS ORIGINAL CLIENT OR FOLLOWING AECOM'S EXPRESS AGREEMENT TO SUCH USE, AND ONLY FOR THE PURPOSES FOR WHICH IT WAS PREPARED AND PROVIDED.

AECOM  
Unit 1 Wellbrook Court,  
Girton,  
Cambridge, CB3 0NA  
United Kingdom  
Telephone (01223) 488000  
www.aecom.com

Drawing Number <b>EN010106/APP/2.5</b>	Rev <b>0</b>
---	-----------------

FOR CONTINUATION - REFER TO SHEET 18

FOR CONTINUATION - REFER TO SHEET 15

FOR CONTINUATION - REFER TO SHEET 17

FOR CONTINUATION - REFER TO SHEET 13



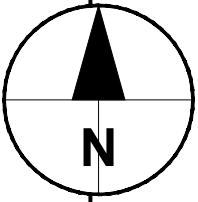
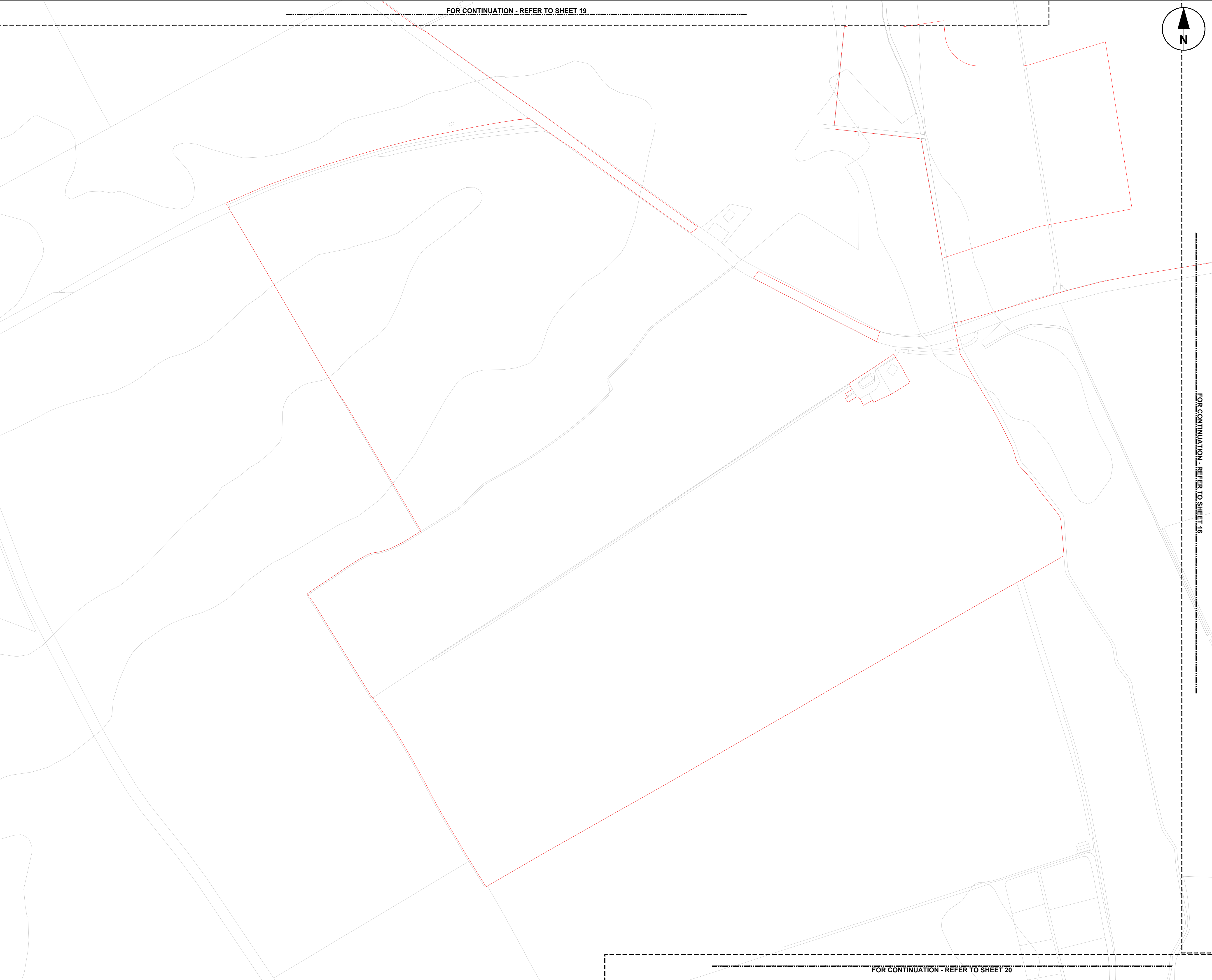

THIS DRAWING IS TO BE USED ONLY FOR THE PURPOSE OF ISSUE THAT IT WAS ISSUED FOR AND IS SUBJECT TO AMENDMENT

NOTES:

Order limits

Copyright:  
Contains OS data © Crown copyright and database right 2021  
Contains public sector information licensed under the Open Government Licence v3.0  
NOTE:  
Document Reference: EN010106/APP/2.5  
APFP Regulation: 5(2)(o)

Purpose of Issue  
**FOR DCO SUBMISSION**

Client  
**SUNNICA LTD**



Drawing Title  
**SUNNICA ENERGY FARM LOCATION PLAN  
SHEET 17 OF 24**

Drawn LE	Checked DW	Approved NC	Date 28/10/21
AECOM Internal Project No. 60589004		Scale @ A3 1:2500	

THIS DOCUMENT HAS BEEN PREPARED PURSUANT TO AND SUBJECT TO THE TERMS OF AECOM'S APPOINTMENT BY ITS CLIENT. AECOM ACCEPTS NO LIABILITY FOR ANY USE OF THIS DOCUMENT OTHER THAN BY ITS ORIGINAL CLIENT OR FOLLOWING AECOM'S EXPRESS AGREEMENT TO SUCH USE, AND ONLY FOR THE PURPOSES FOR WHICH IT WAS PREPARED AND PROVIDED.

AECOM  
Unit 1 Wellbrook Court,  
Gilton,  
Cambridge, CB3 0NA  
United Kingdom  
Telephone (01223) 488000  
www.aecom.com

Drawing Number <b>EN010106/APP/2.5</b>	Rev <b>0</b>
---	-----------------



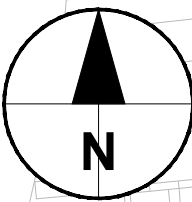
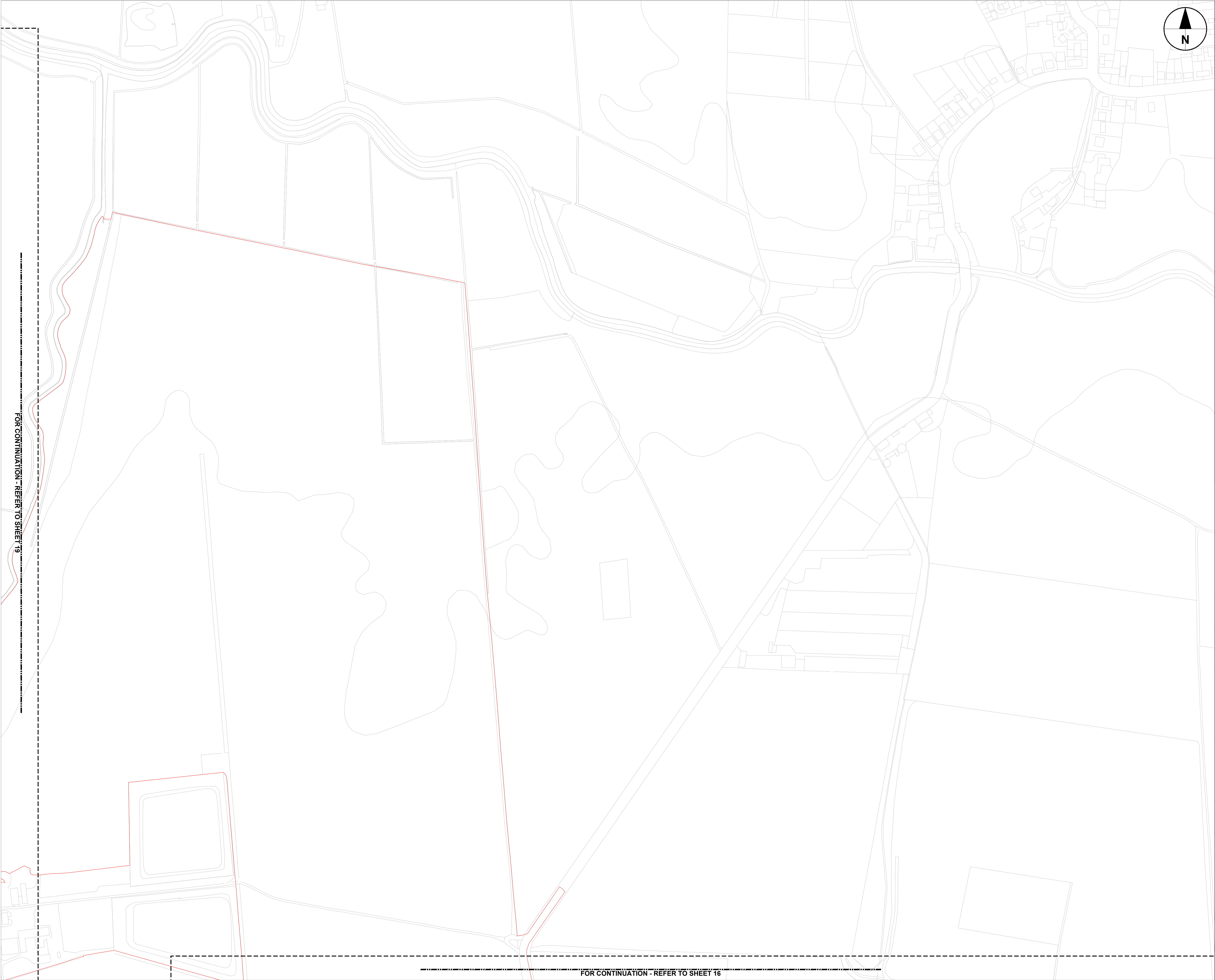

THIS DRAWING IS TO BE USED ONLY FOR THE PURPOSE OF ISSUE THAT IT WAS ISSUED FOR AND IS SUBJECT TO AMENDMENT

NOTES:

Order limits

Copyright:  
Contains OS data © Crown copyright and database right 2021  
Contains public sector information licensed under the Open Government Licence v3.0  
NOTE:  
Document Reference: EN010106/APP/2.5  
APFP Regulation: 5(2)(o)

Purpose of Issue  
**FOR DCO SUBMISSION**

Client  
**SUNNICA LTD**



Drawing Title  
**SUNNICA ENERGY FARM LOCATION PLAN  
SHEET 18 OF 24**

Drawn LE	Checked DW	Approved NC	Date 28/10/21
AECOM Internal Project No. 60589004		Scale @ A3 1:2500	

THIS DOCUMENT HAS BEEN PREPARED PURSUANT TO AND SUBJECT TO THE TERMS OF AECOM'S APPOINTMENT BY ITS CLIENT. AECOM ACCEPTS NO LIABILITY FOR ANY USE OF THIS DOCUMENT OTHER THAN BY ITS ORIGINAL CLIENT OR FOLLOWING AECOM'S EXPRESS AGREEMENT TO SUCH USE, AND ONLY FOR THE PURPOSES FOR WHICH IT WAS PREPARED AND PROVIDED.

AECOM  
Unit 1 Wellbrook Court,  
Girton,  
Cambridge, CB3 0NA  
United Kingdom  
Telephone (01223) 488000  
www.aecom.com

Drawing Number <b>EN010106/APP/2.5</b>	Rev <b>0</b>
---	-----------------



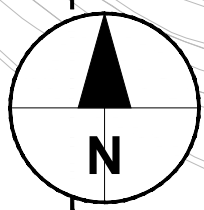

THIS DRAWING IS TO BE USED ONLY FOR THE PURPOSE OF ISSUE THAT IT WAS ISSUED FOR AND IS SUBJECT TO AMENDMENT

NOTES:

Order limits

Copyright:  
Contains OS data © Crown copyright and database right 2021  
Contains public sector information licensed under the Open Government Licence v3.0  
NOTE:  
Document Reference: EN010106/APP/2.5  
APFP Regulation: 5(2)(o)

Purpose of Issue  
**FOR DCO SUBMISSION**

Client  
**SUNNICA LTD**



Drawing Title  
**SUNNICA ENERGY FARM LOCATION PLAN  
SHEET 19 OF 24**

Drawn <b>LE</b>	Checked <b>DW</b>	Approved <b>NC</b>	Date <b>28/10/21</b>
AECOM Internal Project No. <b>60589004</b>		Scale @ A3 <b>1:2500</b>	

THIS DOCUMENT HAS BEEN PREPARED PURSUANT TO AND SUBJECT TO THE TERMS OF AECOM'S APPOINTMENT BY ITS CLIENT. AECOM ACCEPTS NO LIABILITY FOR ANY USE OF THIS DOCUMENT OTHER THAN BY ITS ORIGINAL CLIENT OR FOLLOWING AECOM'S EXPRESS AGREEMENT TO SUCH USE, AND ONLY FOR THE PURPOSES FOR WHICH IT WAS PREPARED AND PROVIDED.

AECOM  
Unit 1 Wellbrook Court,  
Girton,  
Cambridge, CB3 0NA  
United Kingdom  
Telephone (01223) 488000  
www.aecom.com

Drawing Number <b>EN010106/APP/2.5</b>	Rev <b>0</b>
---	-----------------



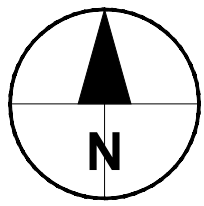
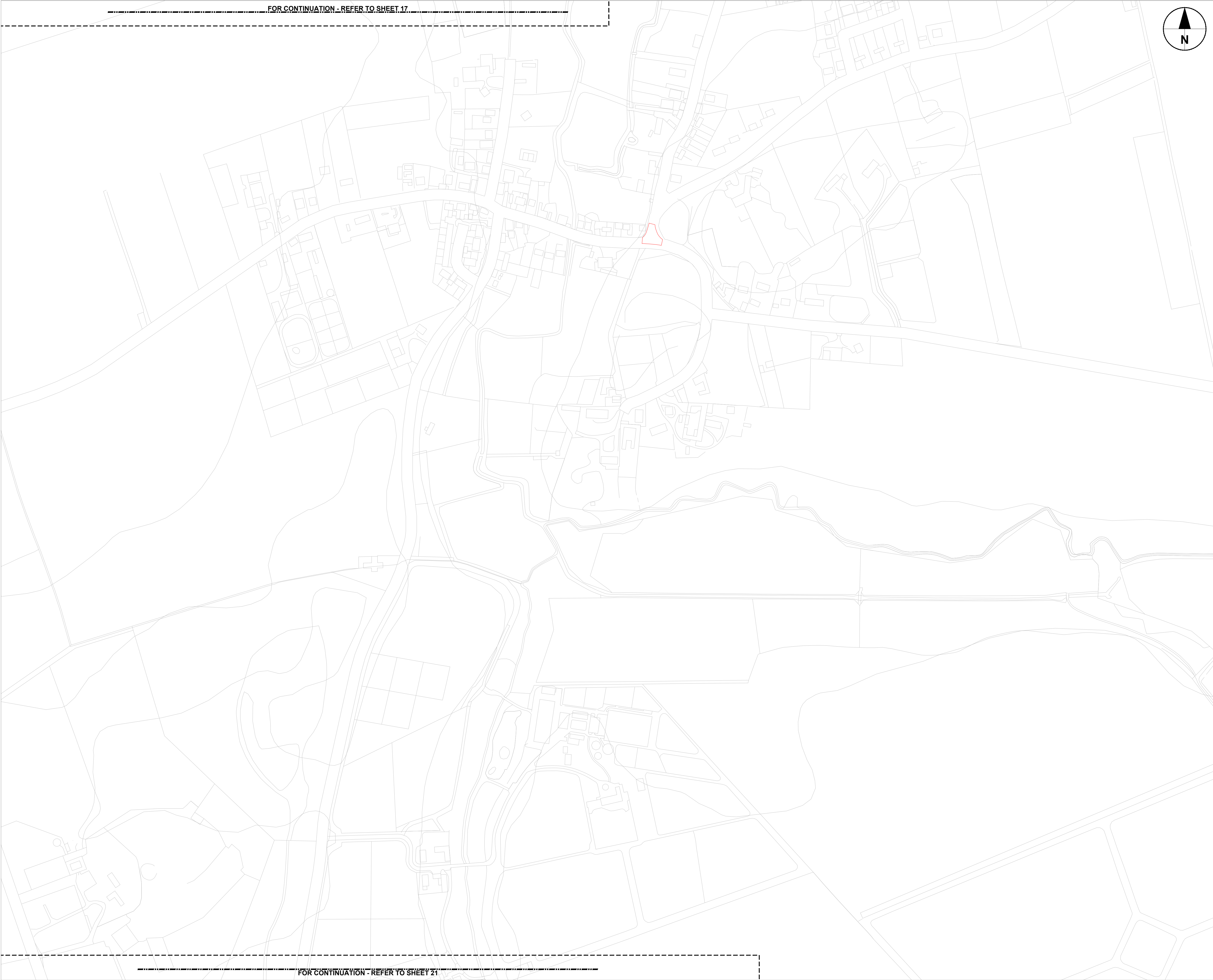

THIS DRAWING IS TO BE USED ONLY FOR THE PURPOSE OF ISSUE THAT IT WAS ISSUED FOR AND IS SUBJECT TO AMENDMENT

NOTES:

Order limits

Copyright:  
Contains OS data © Crown copyright and database right 2021  
Contains public sector information licensed under the Open Government Licence v3.0  
NOTE:  
Document Reference: EN010106/APP/2.5  
APFP Regulation: 5(2)(o)

Purpose of Issue  
**FOR DCO SUBMISSION**

Client  
**SUNNICA LTD**



Drawing Title  
**SUNNICA ENERGY FARM LOCATION PLAN  
SHEET 20 OF 24**

Drawn <b>LE</b>	Checked <b>DW</b>	Approved <b>NC</b>	Date <b>28/10/21</b>
--------------------	----------------------	-----------------------	-------------------------

AECOM Internal Project No. <b>60589004</b>	Scale @ A3 <b>1:2500</b>
---	-----------------------------

THIS DOCUMENT HAS BEEN PREPARED PURSUANT TO AND SUBJECT TO THE TERMS OF AECOM'S APPOINTMENT BY ITS CLIENT. AECOM ACCEPTS NO LIABILITY FOR ANY USE OF THIS DOCUMENT OTHER THAN BY ITS ORIGINAL CLIENT OR FOLLOWING AECOM'S EXPRESS AGREEMENT TO SUCH USE, AND ONLY FOR THE PURPOSES FOR WHICH IT WAS PREPARED AND PROVIDED.

AECOM  
Unit 1 Wellbrook Court,  
Girton,  
Cambridge, CB3 0NA  
United Kingdom  
Telephone (01223) 488000  
www.aecom.com

Drawing Number <b>EN010106/APP/2.5</b>	Rev <b>0</b>
---	-----------------



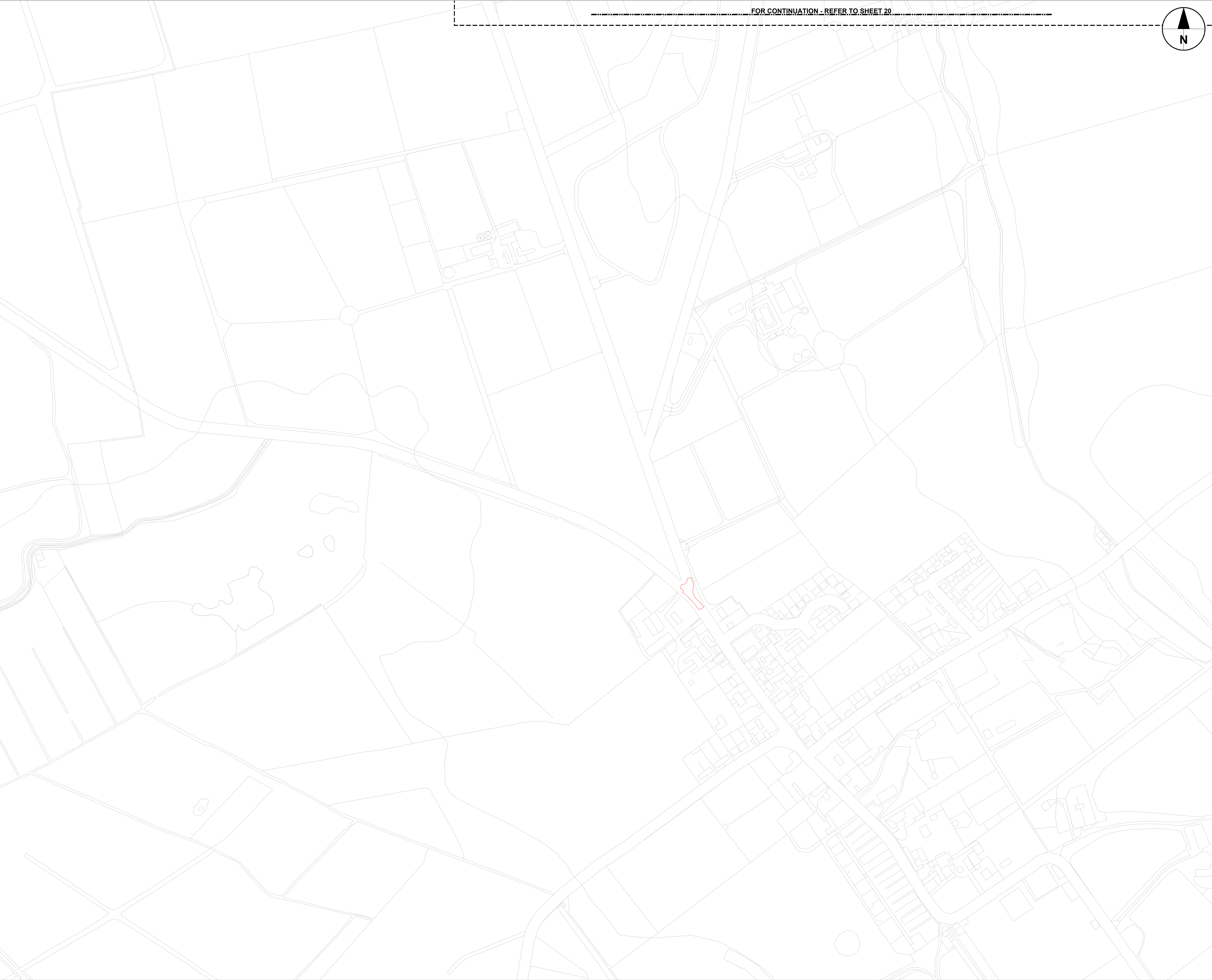

FOR CONTINUATION - REFER TO SHEET 20

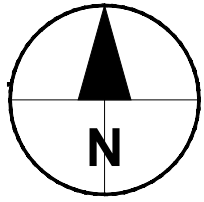

THIS DRAWING IS TO BE USED ONLY FOR THE PURPOSE OF ISSUE THAT IT WAS ISSUED FOR AND IS SUBJECT TO AMENDMENT

NOTES:

Order limits

Copyright:  
Contains OS data © Crown copyright and database right 2021  
Contains public sector information licensed under the Open Government Licence v3.0  
NOTE:  
Document Reference: EN010106/APP/2.5  
APFP Regulation: 5(2)(o)

Purpose of Issue  
FOR DCO SUBMISSION

Client  
SUNNICA LTD



Drawing Title  
SUNNICA ENERGY FARM LOCATION PLAN  
SHEET 21 OF 24

Drawn LE	Checked DW	Approved NC	Date 28/10/21
-------------	---------------	----------------	------------------

AECOM Internal Project No. 60589004	Scale @ A3 1:2500
--	----------------------

THIS DOCUMENT HAS BEEN PREPARED PURSUANT TO AND SUBJECT TO THE TERMS OF AECOM'S APPOINTMENT BY ITS CLIENT. AECOM ACCEPTS NO LIABILITY FOR ANY USE OF THIS DOCUMENT OTHER THAN BY ITS ORIGINAL CLIENT OR FOLLOWING AECOM'S EXPRESS AGREEMENT TO SUCH USE, AND ONLY FOR THE PURPOSES FOR WHICH IT WAS PREPARED AND PROVIDED.

AECOM  
Unit 1 Wellbrook Court,  
Girton,  
Cambridge, CB3 0NA  
United Kingdom  
Telephone (01223) 488000  
www.aecom.com

Drawing Number EN010106/APP/2.5	Rev 0
------------------------------------	----------



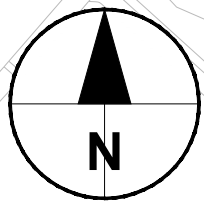

THIS DRAWING IS TO BE USED ONLY FOR THE PURPOSE OF ISSUE THAT IT WAS ISSUED FOR AND IS SUBJECT TO AMENDMENT

NOTES:

Order limits

Copyright:  
Contains OS data © Crown copyright and database right 2021  
Contains public sector information licensed under the Open Government Licence v3.0  
NOTE:  
Document Reference: EN010106/APP/2.5  
APFP Regulation: 5(2)(o)

Purpose of Issue  
FOR DCO SUBMISSION

Client  
SUNNICA LTD



Drawing Title  
SUNNICA ENERGY FARM LOCATION PLAN  
SHEET 22 OF 24

Drawn LE	Checked DW	Approved NC	Date 28/10/21
AECOM Internal Project No. 60589004		Scale @ A3 1:2500	
THIS DOCUMENT HAS BEEN PREPARED PURSUANT TO AND SUBJECT TO THE TERMS OF AECOM'S APPOINTMENT BY ITS CLIENT. AECOM ACCEPTS NO LIABILITY FOR ANY USE OF THIS DOCUMENT OTHER THAN BY ITS ORIGINAL CLIENT OR FOLLOWING AECOM'S EXPRESS AGREEMENT TO SUCH USE, AND ONLY FOR THE PURPOSES FOR WHICH IT WAS PREPARED AND PROVIDED.			
AECOM Unit 1 Wellbrook Court, Girton, Cambridge, CB3 0NA United Kingdom Telephone (01223) 488000 www.aecom.com			
Drawing Number EN010106/APP/2.5			Rev 0

FOR CONTINUATION - REFER TO SHEET 23



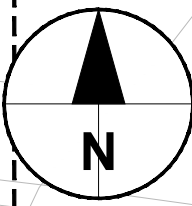

THIS DRAWING IS TO BE USED ONLY FOR THE PURPOSE OF ISSUE THAT IT WAS ISSUED FOR AND IS SUBJECT TO AMENDMENT

NOTES:

Order limits

Copyright:  
Contains OS data © Crown copyright and database right 2021  
Contains public sector information licensed under the Open Government Licence v3.0  
NOTE:  
Document Reference: EN010106/APP/2.5  
APFP Regulation: 5(2)(o)

Purpose of Issue  
**FOR DCO SUBMISSION**

Client  
**SUNNICA LTD**

Project Title  

Drawing Title  
**SUNNICA ENERGY FARM LOCATION PLAN  
SHEET 23 OF 24**

Drawn <b>LE</b>	Checked <b>DW</b>	Approved <b>NC</b>	Date <b>28/10/21</b>
--------------------	----------------------	-----------------------	-------------------------

AECOM Internal Project No. <b>60589004</b>	Scale @ A3 <b>1:2500</b>
---	-----------------------------

THIS DOCUMENT HAS BEEN PREPARED PURSUANT TO AND SUBJECT TO THE TERMS OF AECOM'S APPOINTMENT BY ITS CLIENT. AECOM ACCEPTS NO LIABILITY FOR ANY USE OF THIS DOCUMENT OTHER THAN BY ITS ORIGINAL CLIENT OR FOLLOWING AECOM'S EXPRESS AGREEMENT TO SUCH USE, AND ONLY FOR THE PURPOSES FOR WHICH IT WAS PREPARED AND PROVIDED.

AECOM  
Unit 1 Wellbrook Court,  
Girton,  
Cambridge, CB3 0NA  
United Kingdom  
Telephone (01223) 488000  
www.aecom.com

Drawing Number <b>EN010106/APP/2.5</b>	Rev <b>0</b>
---	-----------------



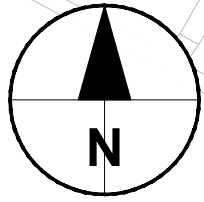

THIS DRAWING IS TO BE USED ONLY FOR THE PURPOSE OF ISSUE THAT IT WAS ISSUED FOR AND IS SUBJECT TO AMENDMENT

NOTES:

Order limits

Copyright:  
Contains OS data © Crown copyright and database right 2021  
Contains public sector information licensed under the Open Government Licence v3.0  
NOTE:  
Document Reference: EN010106/APP/2.5  
APFP Regulation: 5(2)(o)

Purpose of Issue  
**FOR DCO SUBMISSION**

Client  
**SUNNICA LTD**

Project Title  

Drawing Title  
**SUNNICA ENERGY FARM LOCATION PLAN  
SHEET 24 OF 24**

Drawn <b>LE</b>	Checked <b>DW</b>	Approved <b>NC</b>	Date <b>28/10/21</b>
--------------------	----------------------	-----------------------	-------------------------

AECOM Internal Project No. <b>60589004</b>	Scale @ A3 <b>1:2500</b>
---	-----------------------------

THIS DOCUMENT HAS BEEN PREPARED PURSUANT TO AND SUBJECT TO THE TERMS OF AECOM'S APPOINTMENT BY ITS CLIENT. AECOM ACCEPTS NO LIABILITY FOR ANY USE OF THIS DOCUMENT OTHER THAN BY ITS ORIGINAL CLIENT OR FOLLOWING AECOM'S EXPRESS AGREEMENT TO SUCH USE, AND ONLY FOR THE PURPOSES FOR WHICH IT WAS PREPARED AND PROVIDED.

AECOM  
Unit 1 Wellbrook Court,  
Girton,  
Cambridge, CB3 0NA  
United Kingdom  
Telephone (01223) 488000  
www.aecom.com

Drawing Number <b>EN010106/APP/2.5</b>	Rev <b>0</b>
---	-----------------